

TIDE

WFL-530

You no longer have to journey for a relaxing natural experience. A Mirra soothing fountain from HoMedics lets you connect to that same elemental calm by bringing the sounds of the outdoors into your personal setting.



REGISTER YOUR FOUNTAIN

Registering your fountain secures the benefits of your warranty (even if you lose your receipt). It also makes it easier for us to assist you if you ever have an issue with your product.

www.homedics.com/product-registration

UNIQUE FEATURES AND SPECIFICATIONS

Natural water sounds

Soothing sounds create a relaxing ambience.

Unique lighting

Warm glow enhances any environment.

Convenient tabletop size

8" x 8" x 7" for an easy fit on most surfaces.

Adapter voltage

120 VAC, 60Hz

PARTS AND PIECES

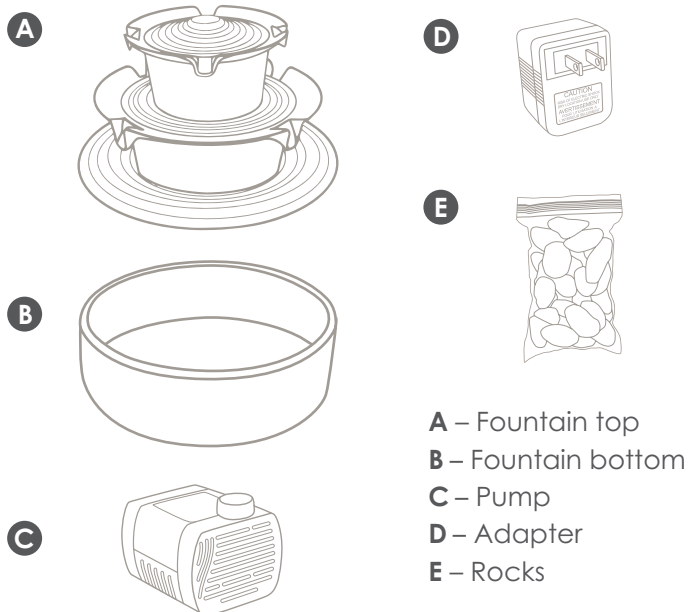

HOW TO USE

Instructions

1. Familiarize yourself with the pump. The switch located at the front of the pump controls the pump speed. The speed is indicated by a plus (+) and minus (-) sign. To increase the speed, move the switch slowly to the left in the direction of the plus sign. At its highest speed level, the switch will cease to move any farther. To decrease the pump speed for less water flow, move the switch to the right toward the minus sign. Similarly, at its lowest speed, the switch will cease to move any farther.
2. Connect the male and female parts of the LED light connector and twist cap tightly.
3. Insert the tube into the pump.
4. Fill base with water up to the fill line. Keep the water filled to the suggested level at all times for optimum performance.
5. Set the fountain top onto the base.
6. Rinse the rocks with water. Arrange the rocks on the platform.
7. Attach the AC adapter jack to the base power cord. DO NOT plug into an outlet at this time.
8. Set the fountain on a level, waterproof surface.
9. Plug the cord into a 120V household outlet. The switch located on the power cord controls the fountain. If the pump doesn't operate, click the power button once to turn the fountain on and once more to turn off.

NOTE: Ensure that the electrical cord loops below the electrical outlet to form a "drip loop." This will prevent water from running down the cord into the electrical outlet.

10. **For the best results, operate with the pump completely submerged. Keep the water level at the fill line at all times.**

TO CLEAN

1. To clean the pump: Unplug from electrical outlet. Use a small brush or stream of water to remove any debris.
2. To keep water clean: Periodically change the water and clean the product according to the water condition. Over time, fountain water and the fountain itself become dirty. We suggest cleaning and exchanging water weekly to increase the longevity of the fountain.
3. To clean off hard water deposits on the base: Soak the base in a mixture of vinegar and water to clean and remove any mineral buildup.
4. Keep water at an optimum level: Add water periodically to keep it at an optimum level to avoid shortening the life of the pump. Never let the pump run dry.
5. Fountain storage: Unplug the fountain from the electrical outlet, empty the water, dry the fountain, and store rocks and fountain in a cool, dry place.

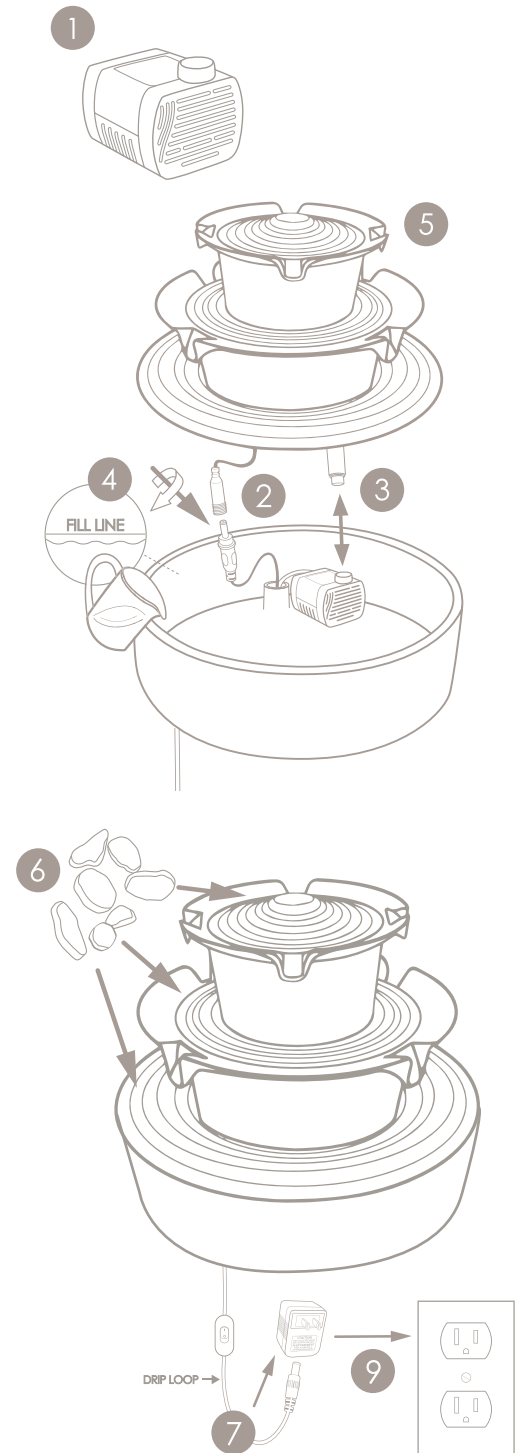

WHEN USING ELECTRICAL PRODUCTS, ESPECIALLY WHEN CHILDREN ARE PRESENT, BASIC SAFETY PRECAUTIONS SHOULD ALWAYS BE FOLLOWED, INCLUDING THE FOLLOWING:

READ ALL INSTRUCTIONS BEFORE USING.

- Always place fountain on a firm, flat surface. Due to the imperfect edges that are inherent to our natural stone fountains, water may splash outside the base of the unit. Therefore, we strongly recommend that you place your fountain and fountain parts on a waterproof surface or that you cover the surface with a waterproof barrier.
- DO NOT place on any surface that can be damaged by water.
- DO NOT reach for a unit that has fallen into water. Unplug it immediately.
- DO NOT place or drop into water or other liquids.
- DO NOT use water above 86°F.
- Use this unit only for its intended purpose as described in this document, the Quick-Start Guide and User Guide.
- DO NOT use attachments not recommended by MIRRA or HoMedics; specifically, any attachments not provided with this unit.
- NEVER drop or insert any object into any opening.
- DO NOT place the fountain near heat sources, such as a stove.
- Always keep the cord away from high temperature and fire.
- To disconnect, turn all controls to the off position, then remove the plug from the outlet.
- DO NOT use outdoors. For indoor use only.
- Never cover the unit while it is operating.
- Perform regular maintenance on the fountain.
- Never use detergent to clean the fountain.
- Never clean the fountain by scraping with a hard object.
- DO NOT attempt to adjust or repair the unit. Servicing must be performed by professional, qualified personnel.
- Stop using this unit if there is an unusual noise or smell.
- Unplug this unit when not in use for a long period of time.
- DO NOT clean, adjust, or move the fountain, or place hands into the water of the fountain without first unplugging it from the electrical outlet.
- Keep this unit out of reach of children.
- Never let the pump run dry, as this will shorten the life of the pump.
- Operate pump completely submerged for proper cooling.
- To ensure quiet operation of pump, you must rinse off all surfaces of your fountain, including the rocks (if provided with your model) before using the first time. Any dirt or residue that remains on the fountain surface may obstruct the water flow through your pump, thereby causing unnecessary noise.
- DO NOT carry this appliance by the power cord or use the cord as a handle.
- Operate with tap or distilled water.
- The pump must be completely submerged in water. If the pump is making noises, most likely it is not completely submerged in water.
- The electric cord of this product cannot be replaced. If it sustains damages, you must stop using the product immediately and contact MIRRA Consumer Relations (see Warranty section for Consumer Relations contact information).

CONTACT US

Questions or concerns? We're here to help. Contact a Consumer Relations representative by phone or email to help answer any questions. Please be sure to have the model number of your product available.

For service in the USA

email: cservice@homedics.com

phone: 1-800-466-3342

8:30am–7:00pm EST Monday–Friday

For service in Canada

email: cservice@homedicsgroup.ca

phone: 1-888-225-7378

8:30am–5:00pm EST Monday–Friday

1-YEAR LIMITED WARRANTY

For detailed warranty instructions, visit www.homedics.com.

To obtain warranty service on your Mirra product, contact a Consumer Relations representative by the telephone number or email address for your country of residence. Please make sure to have the model number of the product available.

For service in the USA

email: cservice@homedics.com

phone: 1-800-466-3342

8:30am–7:00pm EST Monday–Friday

For service in Canada

email: cservice@homedicsgroup.ca

phone: 1-888-225-7378

8:30am–5:00pm EST Monday–Friday

IB-WFL530 | ©2018 HoMedics, LLC.

All rights reserved. | Tous droits réservés. | Todo derechos reservados.

Mirra is a trademark of HoMedics, LLC. | HoMedics is a registered trademark of HoMedics, LLC.

To register your product, visit us online.