

TWO YEAR LIMITED WARRANTY

(Valid in USA only)

HoMedics, Inc., guarantees this product free from defects in material and workmanship for a period of two years from the date of original purchase, except as noted below.

This HoMedics product warranty does not cover damage caused by misuse or abuse; accident; the attachment of any unauthorized accessory; alteration to the product; or any other conditions whatsoever that are beyond the control of HoMedics. This warranty is effective only if the product is purchased and operated in the USA. A product that requires modification or adaptation to enable it to operate in any country other than the country for which it was designed, manufactured, approved and/or authorized, or repair of products damaged by these modifications is not covered under warranty. HoMedics shall not be responsible for any type of incidental, consequential or special damages. All implied warranties, including but not limited to those implied warranties of fitness and merchantability, are limited in the total duration of two years from the original purchase date.

To obtain warranty service on your HoMedics product, either hand deliver or mail the unit and your dated sales receipt (as proof of purchase), postpaid, along with check or money order in the amount of \$5.00 payable to HoMedics, Inc. to cover handling.

Upon receipt, HoMedics will repair or replace, as appropriate, your product and return it to you, postpaid. If it is appropriate to replace your product, HoMedics will replace the product with the same product or a comparable product at HoMedics' option. Warranty is solely through HoMedics Service Center. Service of this product by anyone other than HoMedics Service Center voids warranty.

This warranty provides you with specific legal rights. You may have additional rights which may vary from state to state. Because of individual state regulations, some of the above limitations and exclusions may not apply to you.

For more information regarding our product line in the USA, please visit: www.homedics.com

©2004 HoMedics, Inc. and its affiliated companies, all rights reserved. HoMedics® is a registered trademark of HoMedics Inc. and its affiliated companies. The beauty of living well™ and Float™ are trademarks of HoMedics Inc. and its affiliated companies. All rights reserved.

IB-FMH20A

Float™

Massaging Waterbed for the Feet



Instruction Manual and Warranty Information

FM-H2O

2 year
limited warranty

IMPORTANT SAFEGUARDS
WHEN USING ELECTRICAL PRODUCTS, ESPECIALLY
WHEN CHILDREN ARE PRESENT, BASIC SAFETY
PRECAUTIONS SHOULD ALWAYS BE FOLLOWED,
INCLUDING THE FOLLOWING:
READ ALL INSTRUCTIONS BEFORE USING

DANGER—TO REDUCE THE RISK OF ELECTROCUTION:

- ALWAYS unplug the appliance from the electrical outlet immediately after using and before cleaning.
- DO NOT reach for an appliance that has fallen into water. Unplug it immediately.
- DO NOT use while bathing or showering.
- DO NOT place or store appliance where it can fall or be pulled into a tub or sink.
- DO NOT place in or drop into water or other liquid.
- NEVER use pins or other metallic fasteners with this appliance.
- Keep dry - DO NOT operate in a wet or moist condition.

**WARNING - TO REDUCE THE RISK OF BURNS,
ELECTROCUTION, FIRE OR INJURY TO PERSONS:**

- An appliance should NEVER be left unattended when plugged in. Unplug from outlet when not in use and before putting on or taking off parts or attachments.
- Close supervision is necessary when this appliance is used by, on or near children, invalids or disabled persons.
- Use this appliance only for its intended use as described in this manual. DO NOT use attachments not recommended by HoMedics; specifically any attachments not provided with the unit.

- NEVER operate this appliance if it has a damaged cord or plug, if it is not working properly, if it has been dropped or damaged, or dropped into water. Return it to HoMedics Service Center for examination and repair.
- Keep cord away from heated surfaces.
- NEVER use while sleeping or fall asleep while using the massager.
- NEVER drop or insert any object into any opening.
- DO NOT operate where aerosol (spray) products are being used or where oxygen is being administered.
- DO NOT operate under a blanket or pillow. Excessive heating can occur and cause fire, electrocution or injury to persons.
- DO NOT carry this appliance by supply cord or use cord as handle.
- To disconnect, turn all controls to the “OFF” position, then remove plug from outlet.
- This appliance is designed for household use only.
- DO NOT use outdoors.
- DO NOT use on an infant or invalid or on a sleeping or unconscious person. DO NOT use on insensitive skin or on a person with poor blood circulation.
- DO NOT crush. Avoid sharp folds.
- DO NOT attempt to stand on or in your HoMedics foot massager. Use only while seated.
- Connect this appliance to a properly grounded outlet only. See Grounding Instructions.
- Use heated surfaces carefully. May cause serious burns. DO NOT use over insensitive skin areas or in the presence of poor circulation. The unattended use of heat by children or incapacitated persons may be dangerous.

SAVE THESE INSTRUCTIONS

Caution:
All servicing of this unit must be performed by authorized HoMedics service personnel only.

Caution — Please read all instructions carefully before operating.

- If you have any concerns regarding your health consult your doctor before using this product.
- Individuals with pacemakers should consult a doctor before use.
- NEVER leave the appliance unattended, especially if children are present.
- NEVER cover the appliance when it is in operation.
- DO NOT use this product for more than 15 minutes at a time.
- Extensive use could lead to the product's excessive heating and shorter life. Should this occur, discontinue use and allow the unit to cool before operating.
- NEVER use this product directly on swollen or inflamed areas or skin eruptions.
- This product is a non-professional appliance designed to provide soothing massage to worn muscles. DO NOT use this product as a substitute for medical attention.
- DO NOT use this product before bed. The massage has a stimulating effect and can delay sleep.
- NEVER use this product while in bed.
- This product should NEVER be used by any individual suffering from any physical ailment that would limit the user's capacity to operate the controls or who has sensory deficiencies in the lower half of their body.
- This unit should not be used by children or invalids without adult supervision.

Grounding Instructions

This product must be grounded. If it should malfunction or breakdown, grounding provides a path of least resistance for the electric current to reduce the risk of electric shock. This product is equipped with a cord having an equipment-grounding conductor and a grounding plug. The plug must be plugged into an appropriate outlet that is properly installed and grounded in accordance with all local codes and ordinances.

DANGER

Improper connection of the equipment-grounding conductor can result in a risk of electric shock. Check with a qualified electrician or serviceman if you are in doubt as to whether the product is properly grounded. Do not modify the plug provided with the product - if it will not fit the outlet, you may temporarily use an adapter (such as the one shown in Figure B) until you have a proper outlet (such as the one shown in Figure C) installed by a qualified electrician.

This product is for use on a nominal 120-volt circuit, and has a grounding plug that looks like the plug illustrated in **Figure A**. A temporary adapter that looks like the adapter illustrated in **Figure B** may be used to connect this plug to a 2-pole receptacle as shown in **Figure D** if a properly grounded outlet is not available. The temporary adapter should be used only until a properly grounded outlet **Figure C** can be installed by a qualified electrician. The tab for grounding screw **Figure B** extending from the adapter must be connected to a permanent ground such as a properly grounded outlet box cover. Whenever the adapter is used, it must be held in place by a metal screw. **See Figures D and E**

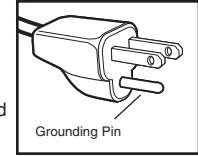

Figure A

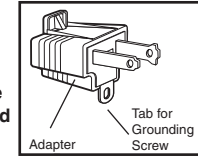

Figure B

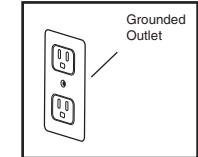

Figure C

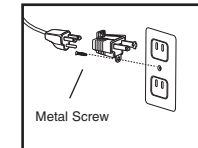

Figure D

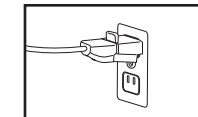

Figure E

Instructions for Use

1. Ensure that the unit is unplugged before filling. Turn the cap (See Figure 1) counter-clockwise one-half rotation and remove.
2. Add one packet of the provided water conditioner to the unit. Any time that you fill the unit with water, water conditioner must be added. You may leave water in the massager for up to 6 months.

NOTE: Once you have used all of the provided water conditioner, you may use any commercially available water conditioner for waterbeds. It is often located in the bedding section of general merchandise stores. The amount to be added is 1/2 oz. (approx. one tablespoon) and not the amount recommended for a waterbed mattress.

3. Fill with water to the red fill line located inside the spout (See Figure 2). Do not fill higher than the fill line.
4. Replace the cap by placing it upside down on the spout (See Figure 3) and turn clockwise half a rotation. The cap should lock into place.
5. Plug the unit into a 120-volt household outlet.
6. To turn the unit ON, press the silver button in the center of the control panel (see Figure 4).
 - a. The first press of the button will activate the invigorating vibration massage. The blue Massage button will illuminate to confirm your selection and the water mattress will also be illuminated in blue.
 - b. The second press of the button will activate the Heat feature with the massage. The red Heat button will illuminate to confirm your selection and the water mattress will also be illuminated in red.
 - c. The third press of the button will turn the unit OFF.

NOTE: Water heat will only work while the massage feature is on. It will take approximately 3 minutes for the water to heat up.

7. Enjoy the massage by resting your feet or sliding them across the water mattress. **NOTE:** You must be seated to use the massager. Do not stand on the massager.
8. When you are finished using your massager, turn the unit off and unplug it.
9. You may leave water in your massager for up to 6 months. If you are not going to use it for an extended period of time, it would be best to empty the water.

To empty: First, unplug the unit. Second, turn the cap counter-clockwise one-half rotation and remove as noted in Step 1. Then tip the unit, allowing water to flow out of the spout. **DO NOT** pour water over the control panel.



Figure 1

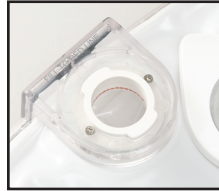

Figure 2



Figure 3



Figure 4

Maintenance

To Clean

Unplug the unit and allow it to cool before cleaning.

- Clean the exterior with a soft, damp cloth and a mild cleansing agent.
- If necessary, you may periodically clean the inside of the water mattress by filling it with a solution of 10 parts water to 1 part household bleach as needed. After approximately 5 minutes time, pour out the water-bleach solution. Refill with water and then pour it back out to rinse out the water mattress. **DO NOT** operate the unit with the water-bleach solution.
- After cleaning, wipe surfaces with a dry cloth.
- Never use strong abrasives, detergents or cleansing agents except as noted with the water-bleach solution.
- Periodically straighten the cord if it becomes twisted.

To Store

Unplug the appliance from the outlet and allow to cool.

- Empty the water as noted in Step 9 in the Instructions for Use.
- Wipe the unit with a dry cloth.
- Store in its box or a clean, dry place.
- Wrap the power cord around the cord storage in the bottom of the unit.
- To avoid breakage, do not wrap the power cord around the unit.
- Do not hang the unit by the power cord.

Float™

Massaging Waterbed for the Feet

CAUTION: DO NOT FILL WATER OVER THE RED FILL LINE

CAUTION: NEVER TURN MASSAGER ON WITHOUT WATER IN IT

